



Caleb Rempel
portfolio
caleb@artrempel.ca 613-601-1813



CMoT

Canadian Ministry of Technology
Caleb Rempel DSN-3033 (020) February 26 2008

Canadian Ministry of Technology Fit-Up

CMoT is a two-floor government fit-up in an existing structure, for an IT department of the Government of Canada using their fit-up standards. The main focus of the project was not only to create a sustainable and productive workspace that met all performance criteria, but also to create a more satisfying environment for the employee/employer exchange to take place. This project also included (as standard on all projects) a complete working drawings package; of which a sample is provided.

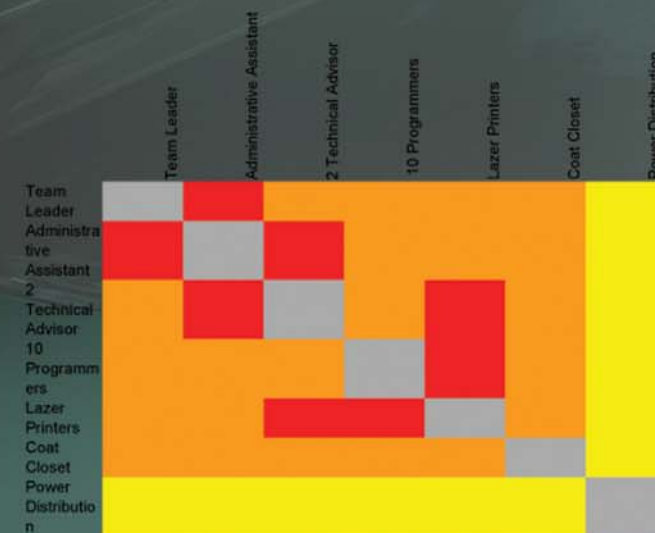
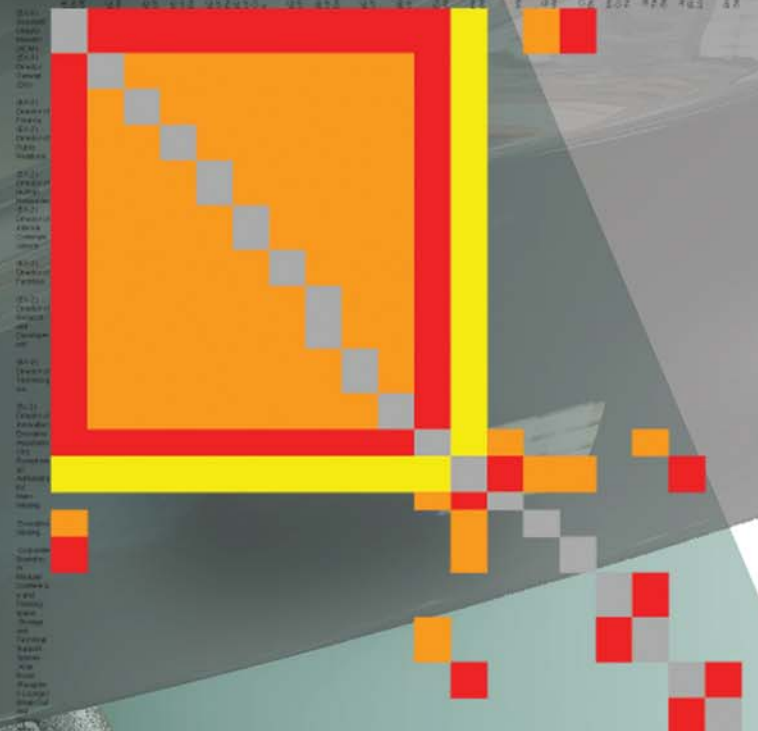
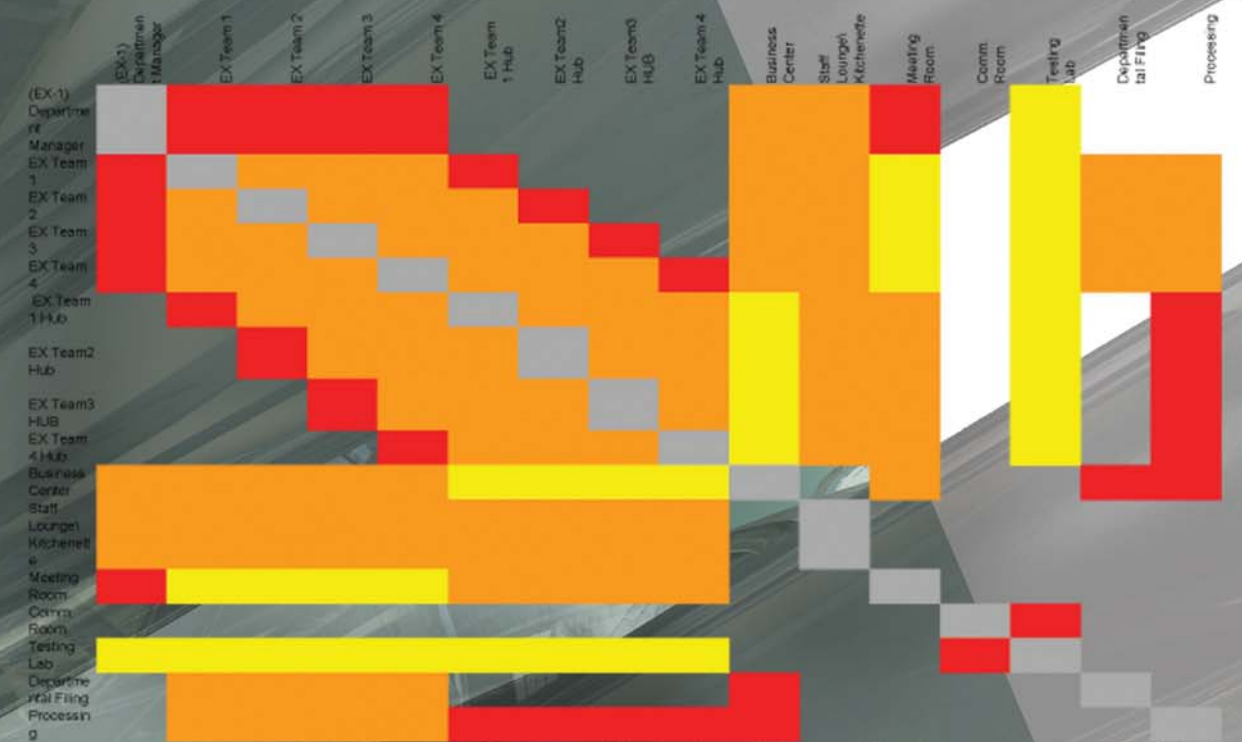
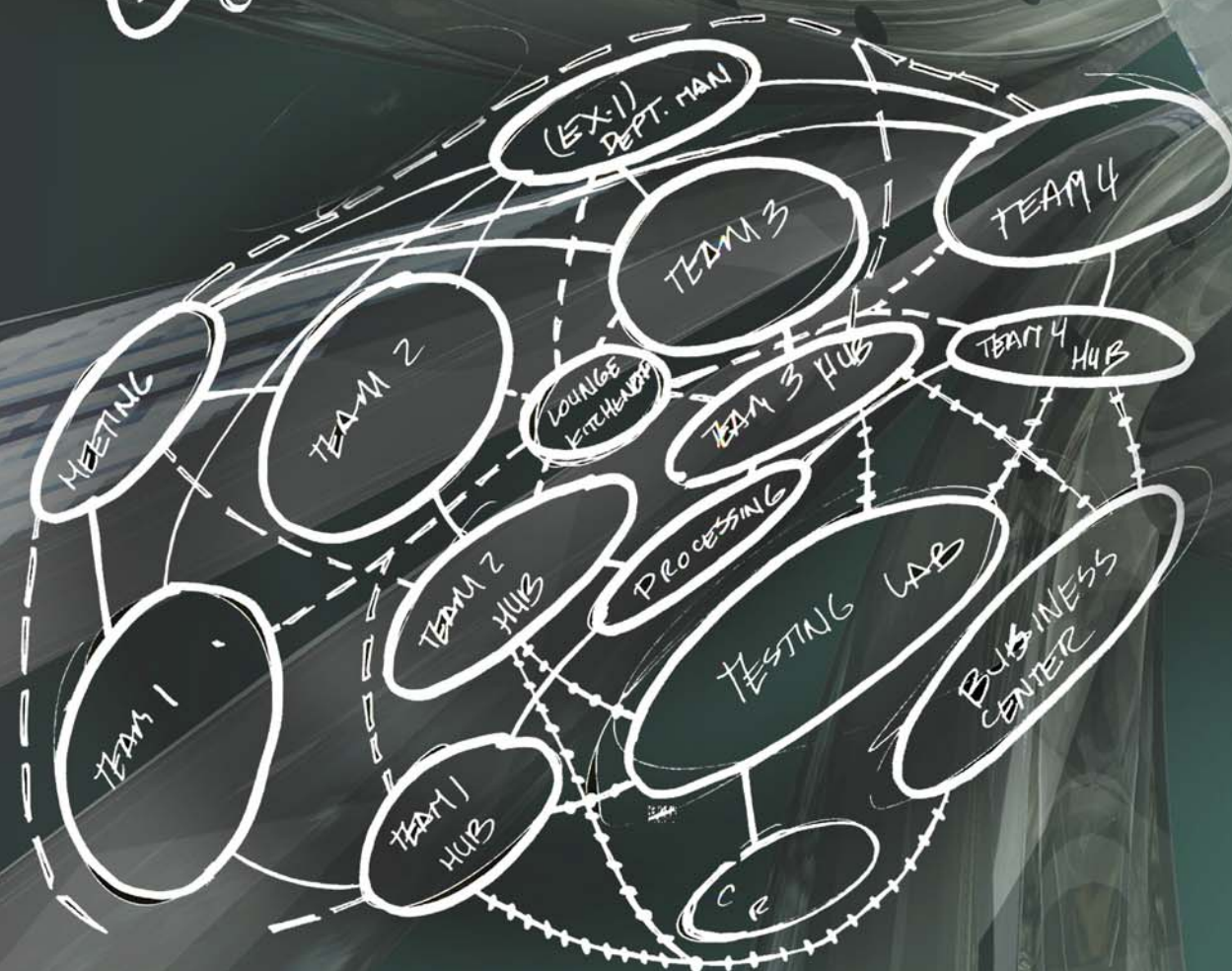
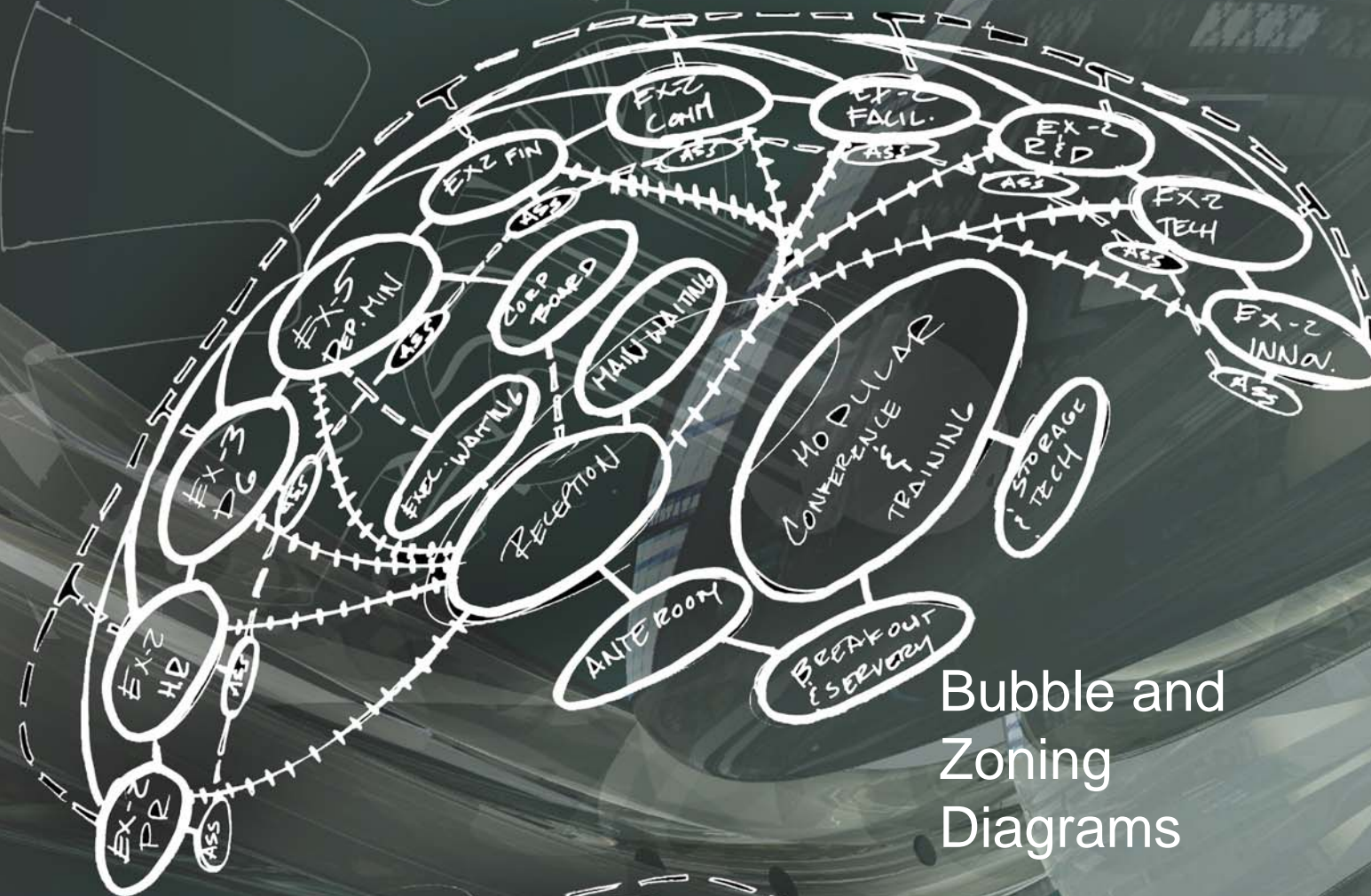

8' Door Blocking Window
 Glass Entry DEN-3075 (100)
 1/1/03

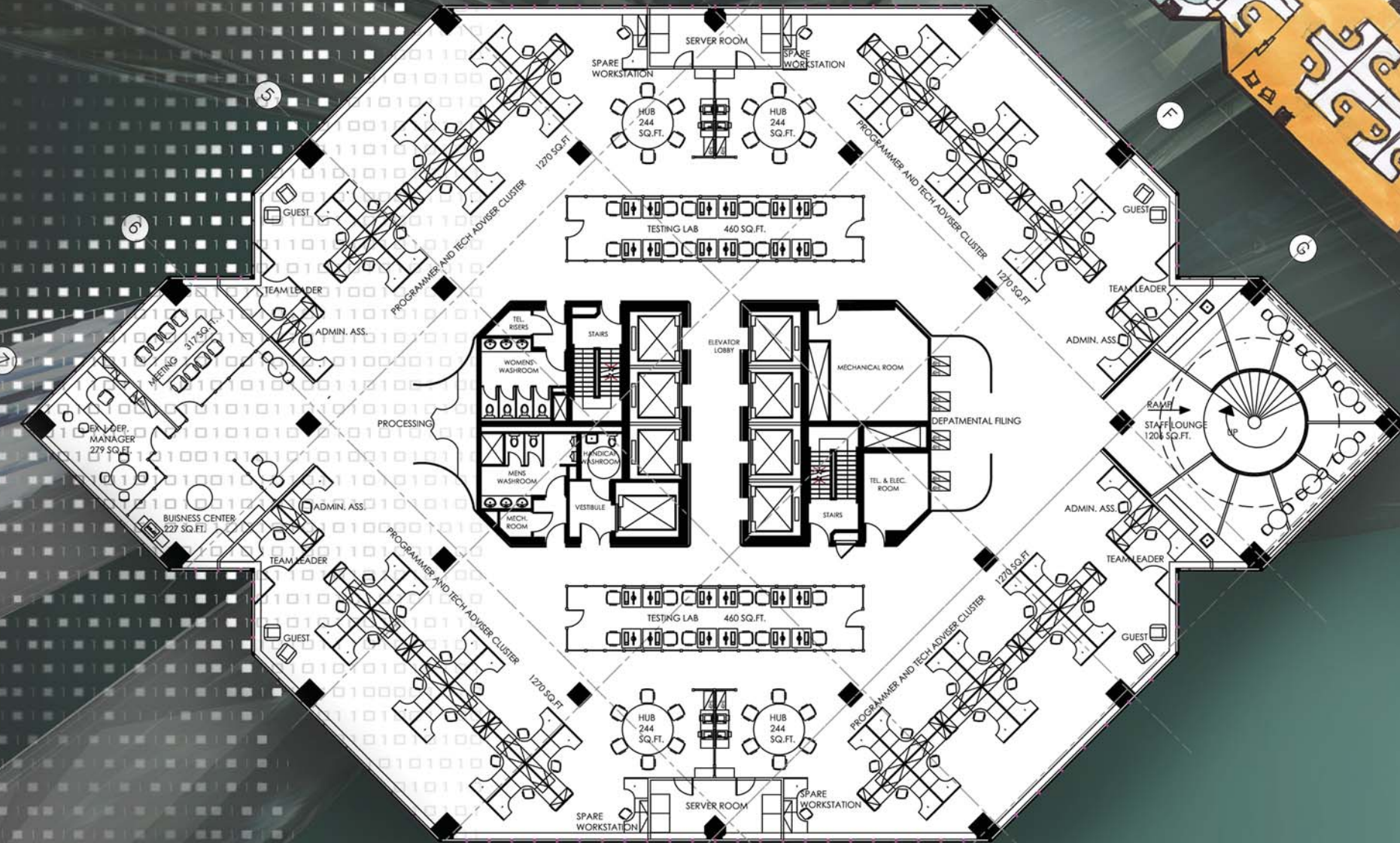
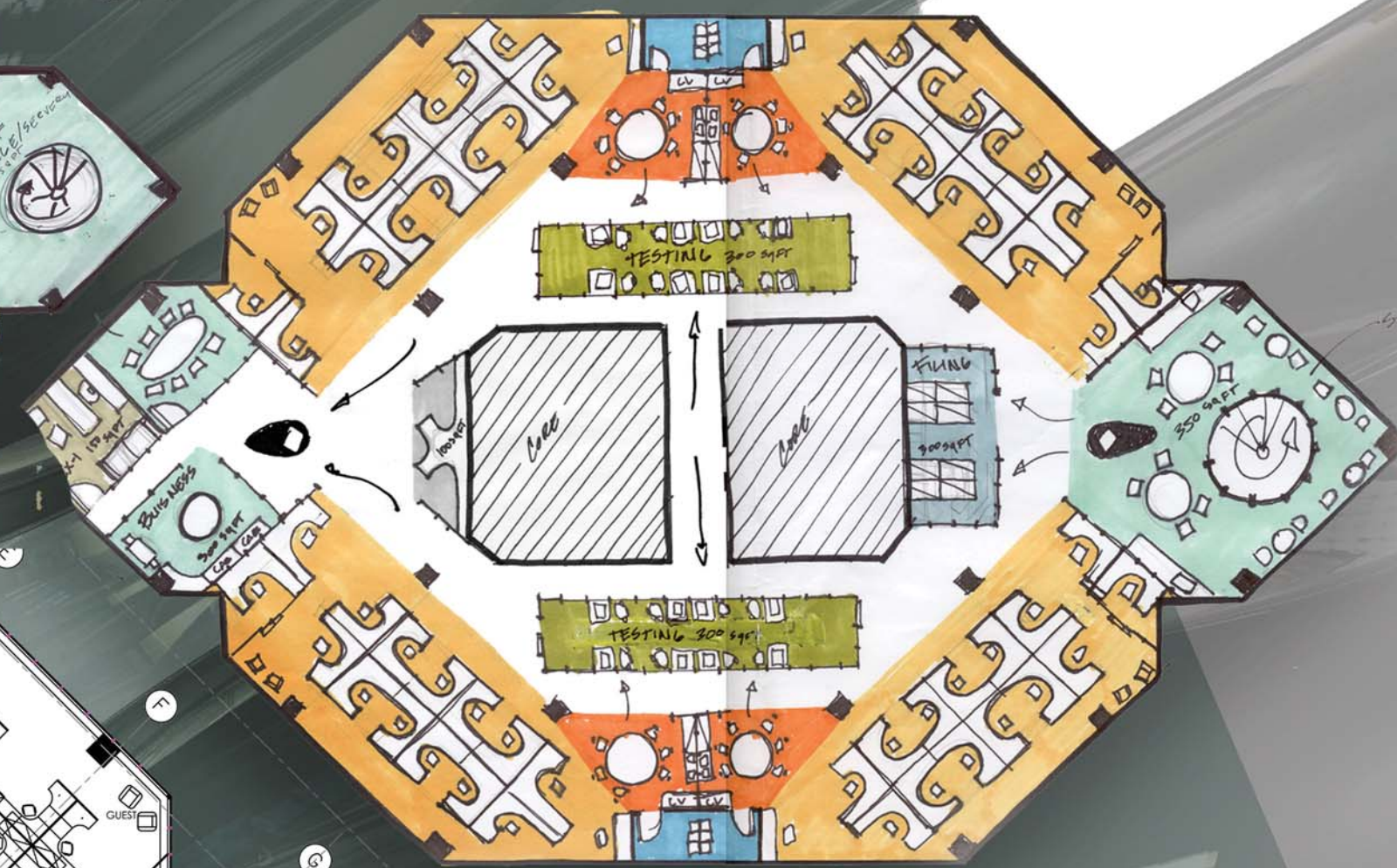
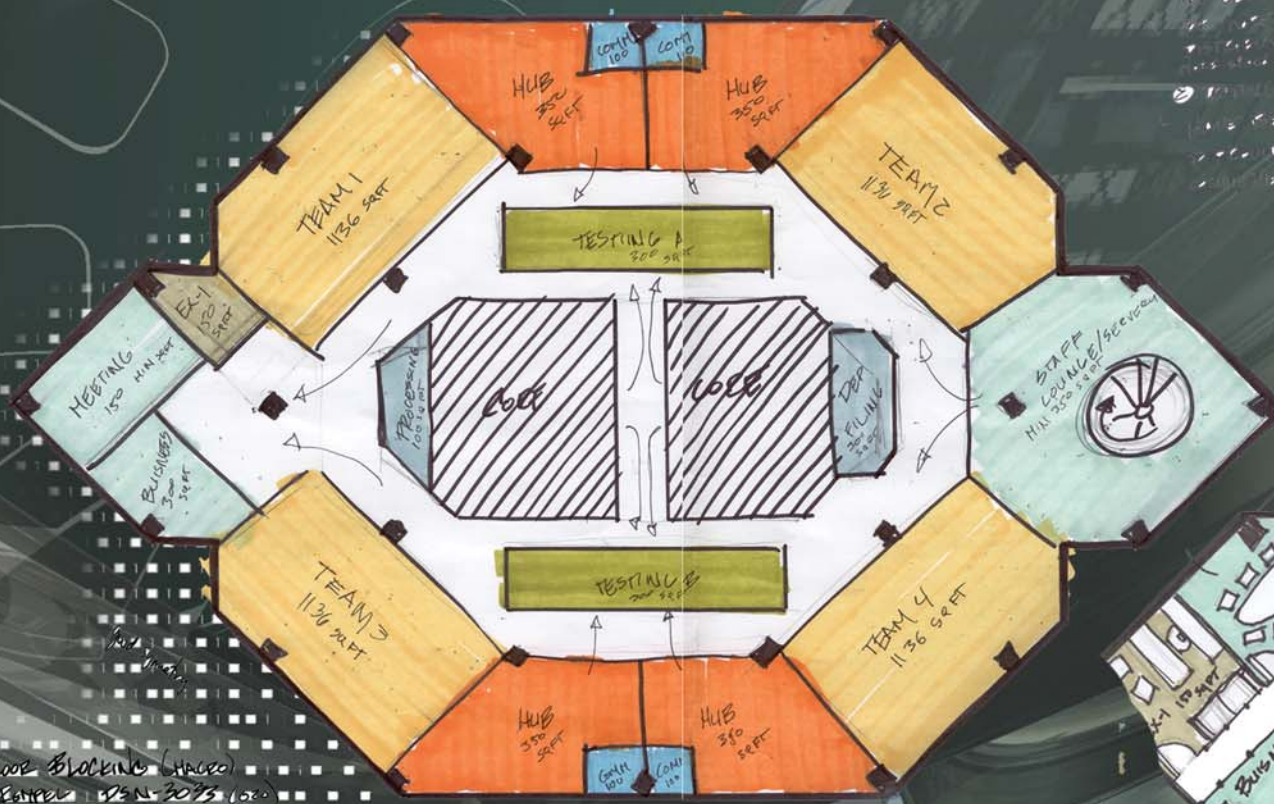

Macro to Micro Planning Stages (8th Floor)

Canadian Ministry of Technology Fit-Up



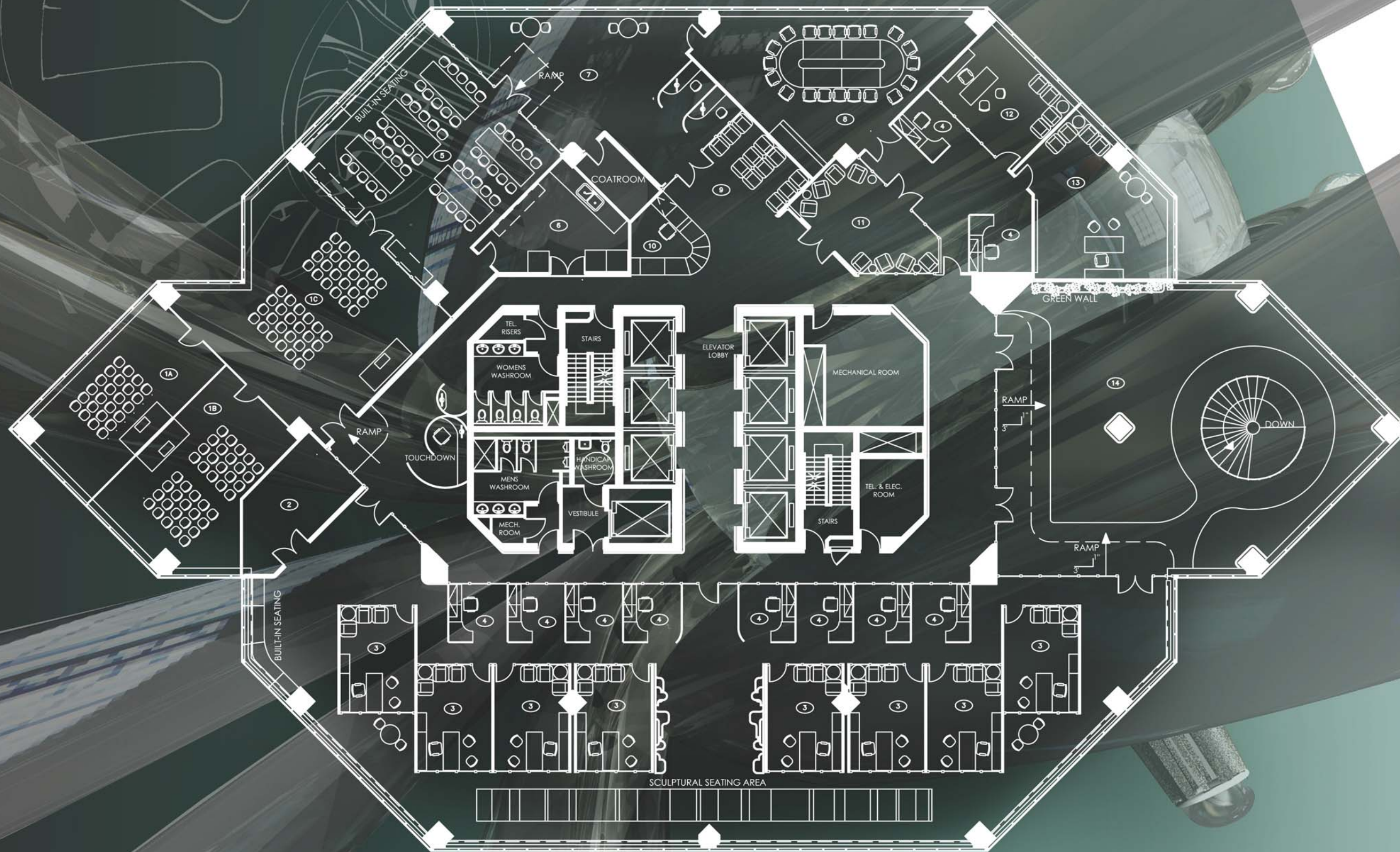

- 1A MODULAR CONFERENCE B 432 SQ. FT.
- 1B MODULAR CONFERENCE C 519 SQ. FT.
- 1C MODULAR CONFERENCE A 909 SQ. FT.
- 2 STORAGE 229 SQ. FT.
- 3 EX-2 200 SQ. FT.
- 4 EXEC. ASS. 910 SQ. FT.
- 5 BREAKOUT AND SERVERY 275 SQ. FT.
- 6 PREPARATION 800 SQ. FT.
- 7 ANTEROOM 675 SQ. FT.
- 8 CORPORATE BOARDROOM CUSTOM TABLE TBD 163 SQ. FT.
- 9 MAIN WAITING 250 SQ. FT.
- 10 RECEPTION 250 SQ. FT.
- 11 EXEC. WAITING 250 SQ. FT.
- 12 DG 250 SQ. FT.
- 13 ADM 432 SQ. FT.
- 14 RAISED VEGETATION TERRACE 6" ABOVE SLAB 2215 SQ. FT.

9th Floor Plan



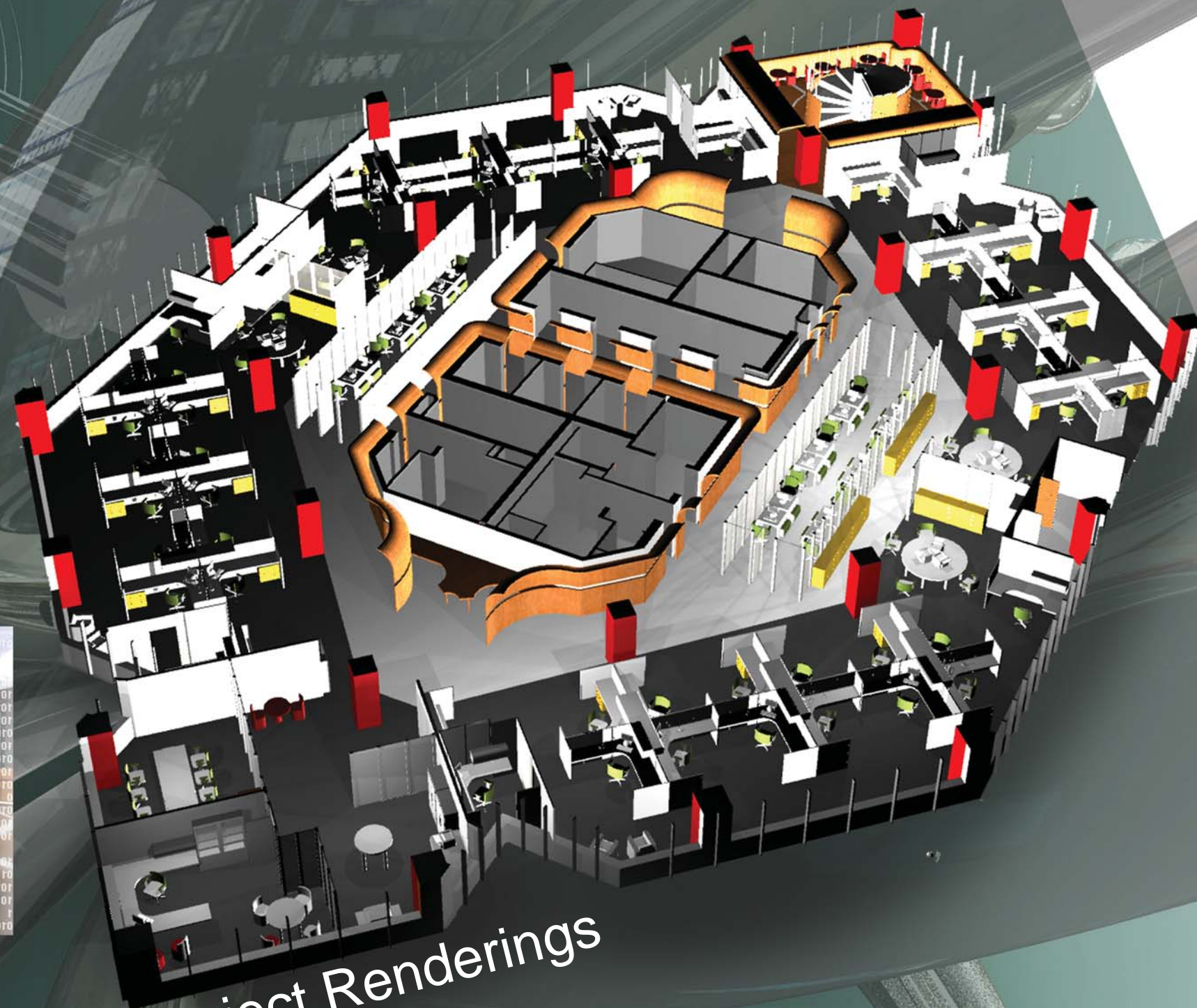

Project Renderings

Canadian Ministry of Technology Fit-Up

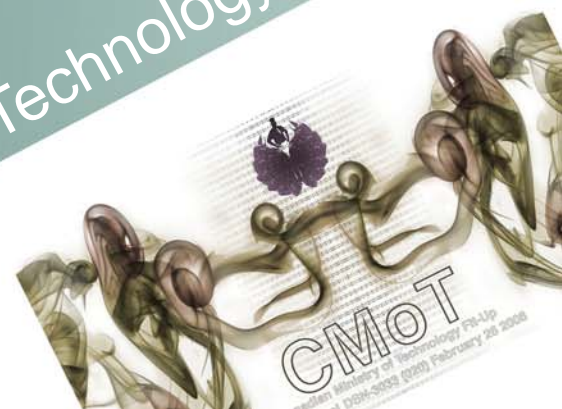

Rorschach Nightclub and Restaurant
Caleb Rempel
DSN 3053 March 3rd 2009

Rorschach Restaurant and Nightclub

Rorschach is a six floor (with mezzanines) restaurant and nightclub. This project focused mainly of vertical versus horizontal volume issues, as some areas were to inevitably interact but had to remain separate at the same time. This created a wonderful opportunity for some unorthodox methodology and thought processes.

ROOM/AREA	MAIN STAIRS	MAIN ELEVATORS	STAFF ELEVATORS	FRIEGHT ELEVATORS	VESTIBULE	PUBLIC W/C	STAFF UNISEX W/C	PUBLIC W/C ANTEROOM	ELECTRICAL BOX	SECONDARY BAR	MAIN BAR	BACK OF HOUSE	HOST STATION	DANCE FLOOR	BAR STOCK STORAGE	DJ	INTERNAL ELEVATORS
MAIN STAIRS																	
MAIN ELEVATORS																	
STAFF ELEVATORS																	
FRIEGHT ELEVATORS																	
VESTIBULE																	
PUBLIC W/C																	
STAFF UNISEX W/C																	
PUBLIC W/C ANTEROOM																	
ELECTRICAL BOX																	
SECONDARY BAR																	
MAIN BAR																	
BACK OF HOUSE																	
HOST STATION																	
DANCE FLOOR																	
BAR STOCK STORAGE																	
DJ																	
INTERNAL ELEVATORS																	

ROOM/AREA	MAIN STAIRS	MAIN ELEVATORS	STAFF ELEVATORS	FRIEGHT ELEVATORS	PUBLIC W/C	STAFF UNISEX W/C	ANTEROOM	PUBLIC W/C ANTEROC	ELECTRICAL BOX	INTERNAL ELEVATORS	PREP AREA	SMALL BAR	CONCIERGE STATION	TRANSACTION AREA	EXHIBIT SPACE	LOUNGE DINING
MAIN STAIRS																
MAIN ELEVATORS																
STAFF ELEVATORS																
FRIEGHT ELEVATORS																
PUBLIC W/C																
STAFF UNISEX W/C																
ANTEROOM																
PUBLIC W/C ANTEROC																
ELECTRICAL BOX																
INTERNAL ELEVATORS																
PREP AREA																
SMALL BAR																
CONCIERGE STATION																
TRANSACTION AREA																
EXHIBIT SPACE																
LOUNGE DINING																

ROOM/AREA	MAIN STAIRS	MAIN ELEVATORS	STAFF ELEVATORS	FRIEGHT ELEVATORS	EXHIBIT SPACE	STAFF UNISEX W/C	ELECTRICAL BOX	KITCHEN	STORAGE	FOOD PREP AREA
MAIN STAIRS										
MAIN ELEVATORS										
STAFF ELEVATORS										
FRIEGHT ELEVATORS										
EXHIBIT SPACE										
STAFF UNISEX W/C										
ELECTRICAL BOX										
KITCHEN										
STORAGE										
FOOD PREP AREA										



Blocking and Adjacency Matrices

Rorschach Restaurant Nightclub



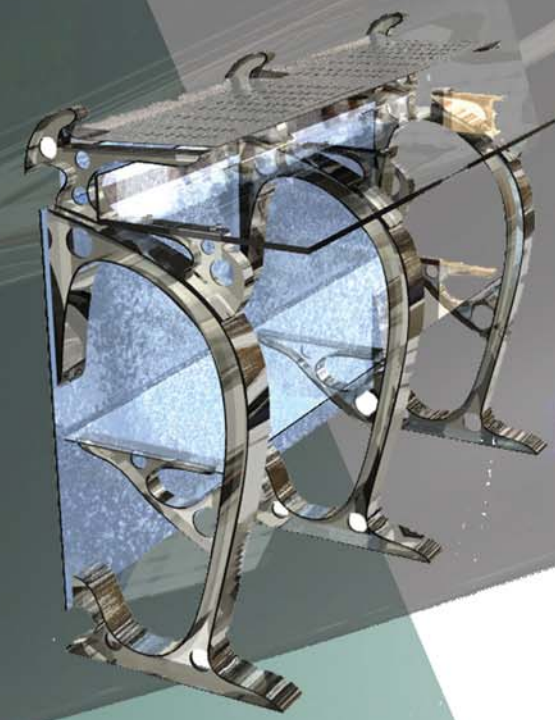
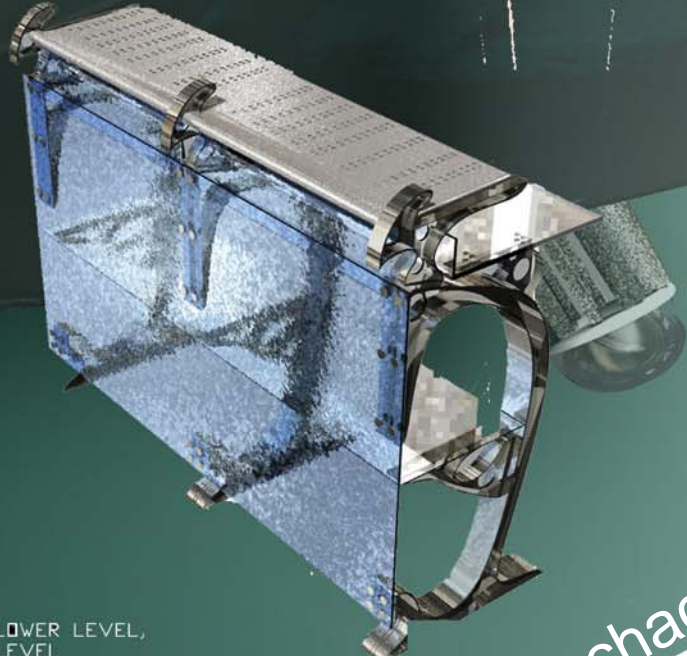
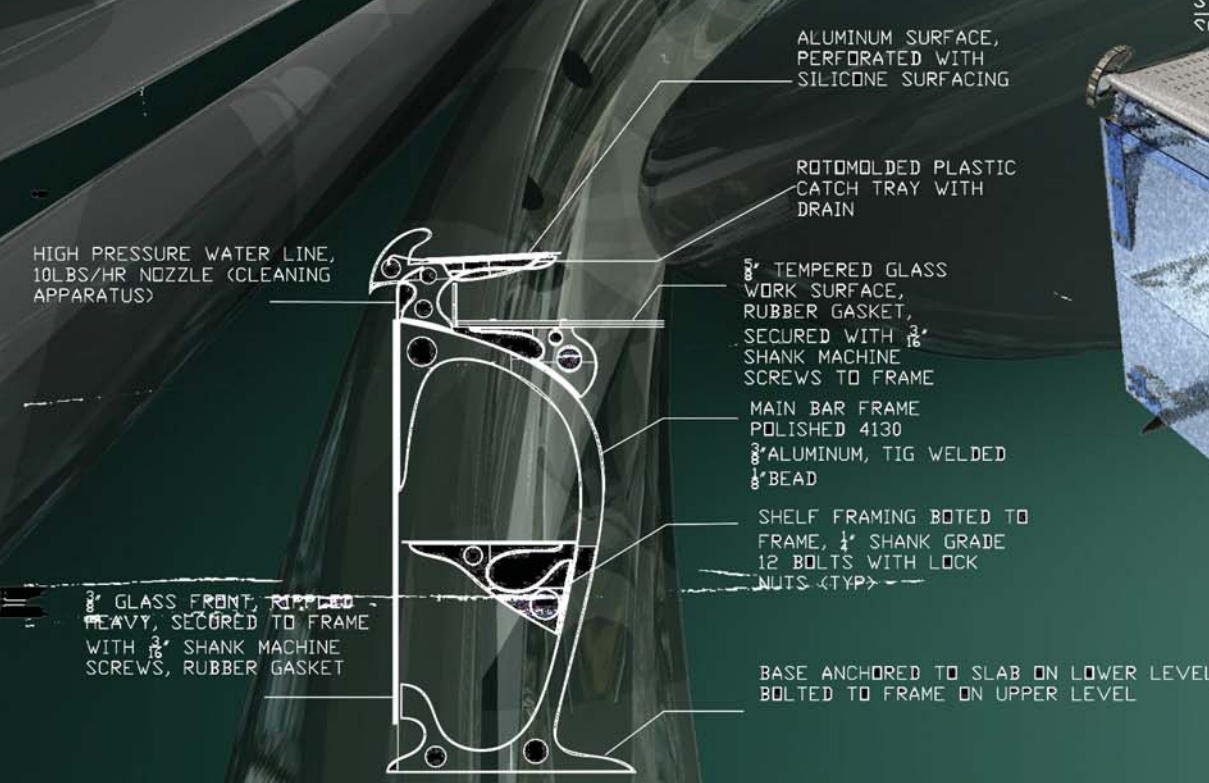
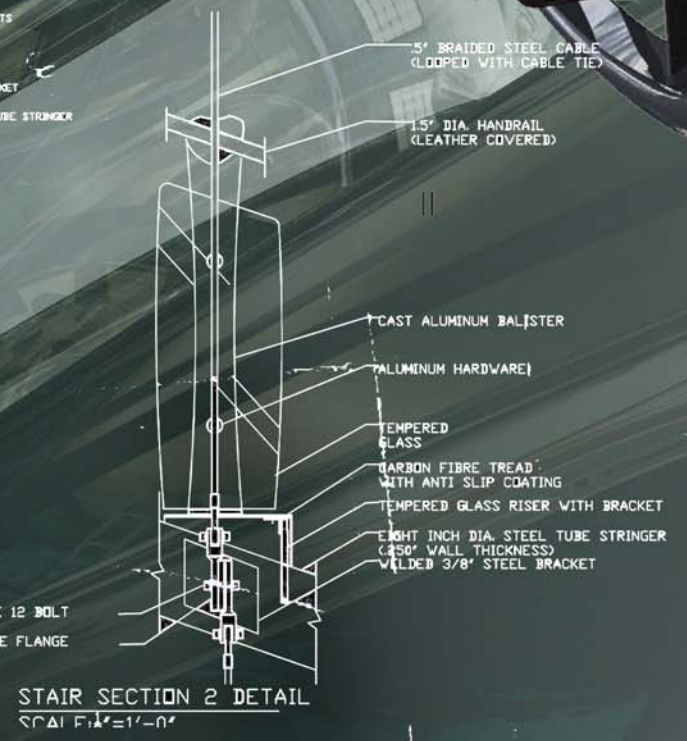
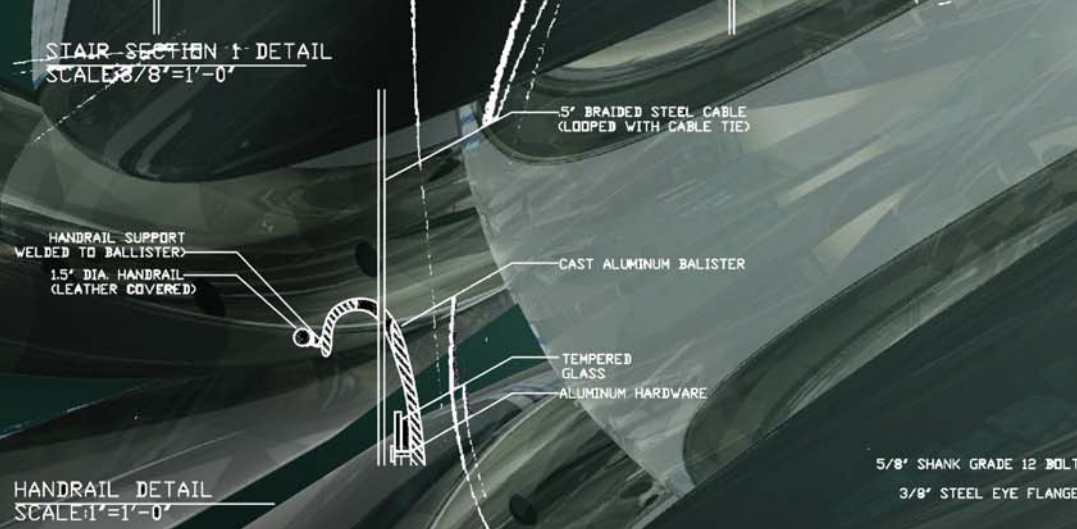
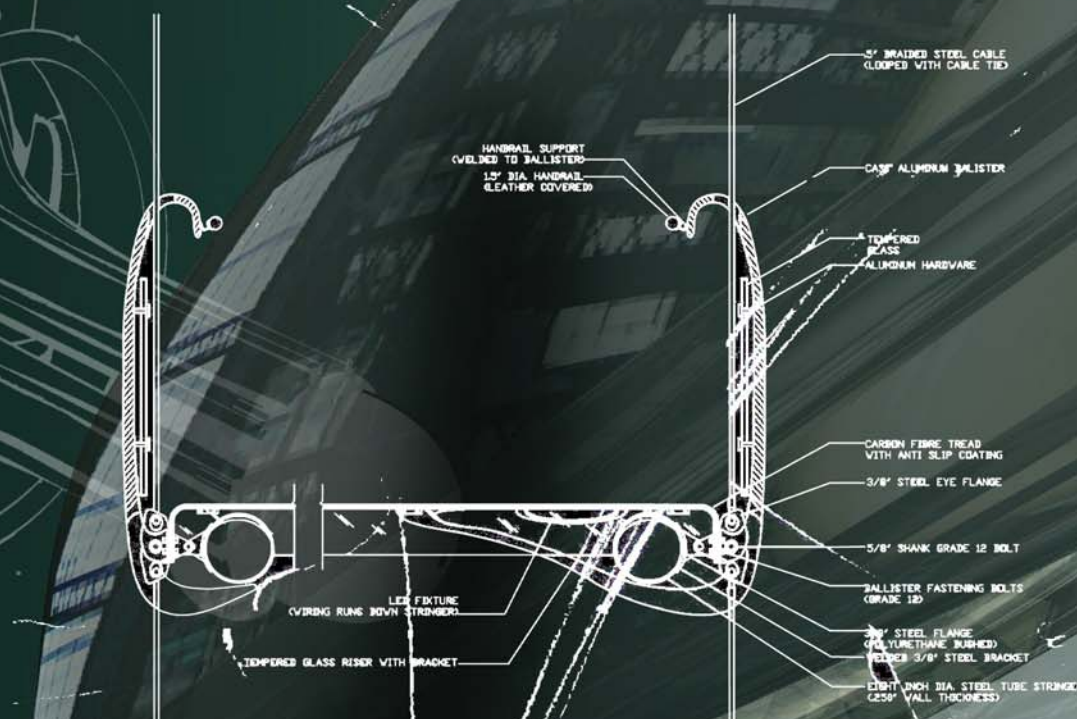
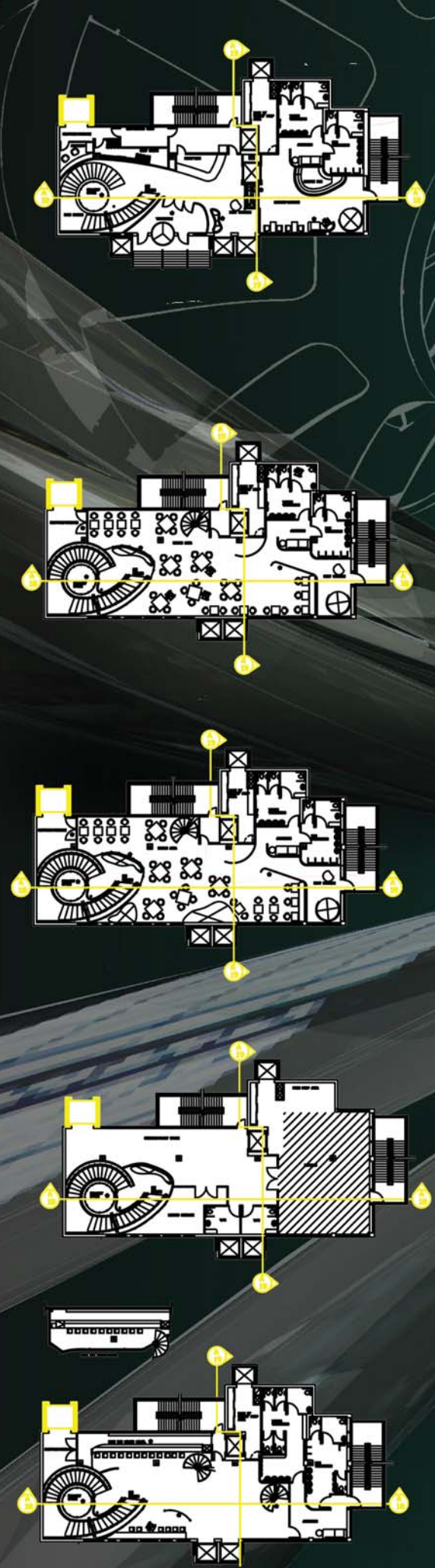

Rorschach Restaurant Nightclub





Project Renderings



Kitchen Area
(outside design contract)



Rorschach Restaurant Nightclub





RISE:ottawa

Paediatric Rehabilitation Hospital

DSN-3048

Caleb Rempel Dana Tapak

October 6 2008

RISE:ottawa Paediatric Hospital

RISE:ottawa a paediatric healthcare facility, with one floor in-patient and one floor out-patient. The focus of treatment was our choice, and mine was that of a rehabilitative program heavily influenced by the arts. The theory was: exercise the mind, and the body will follow. There were many areas in which to achieve this goal, like the recording studio, the theatre, or the pottery area. All of this was in addition to the capacities of a regular rehabilitative hospital, i.e. gymnasium, snoezelen room, etc.

Concept Sketches

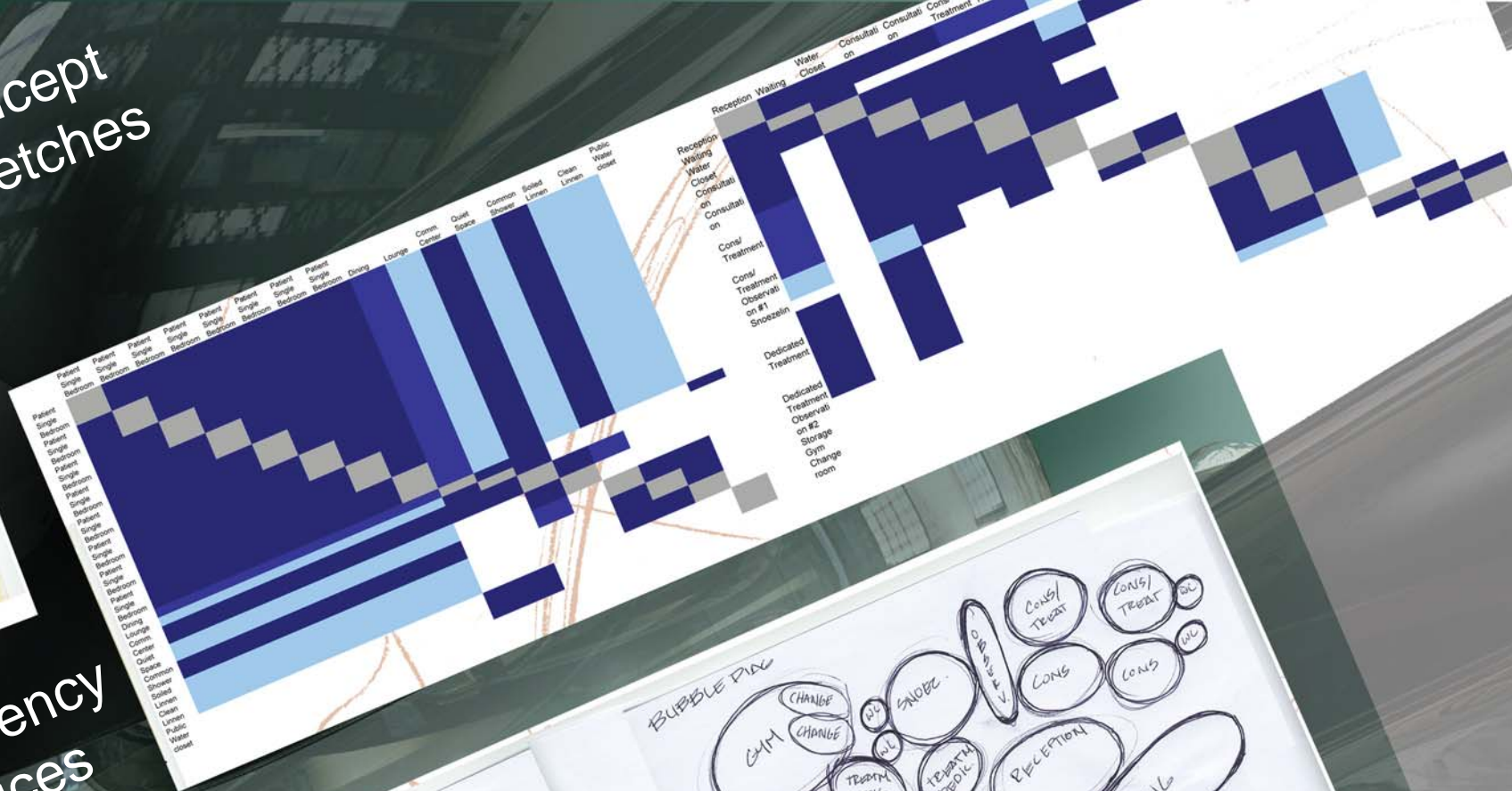
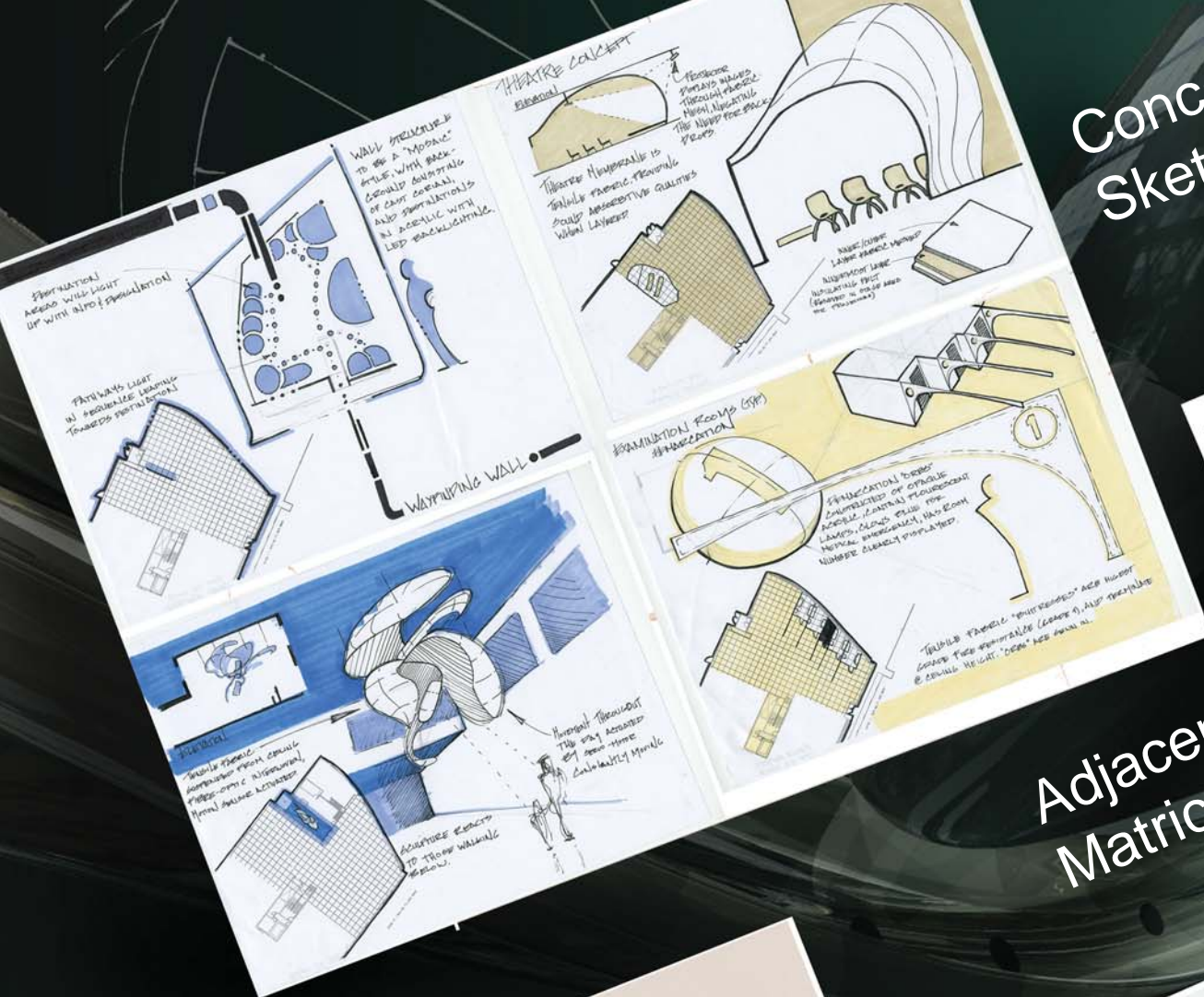

Adjacency Matrices

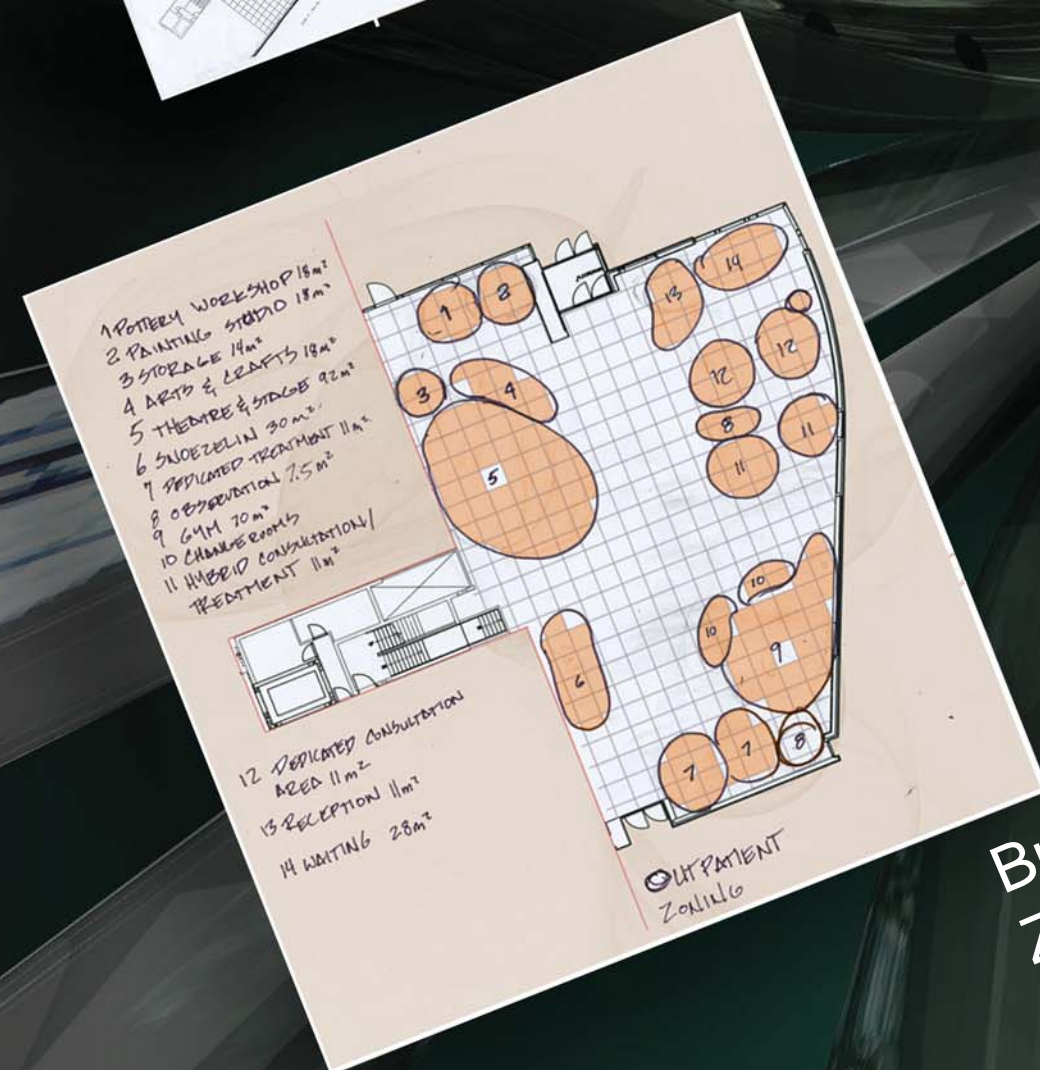

Rise Paediatric Centre

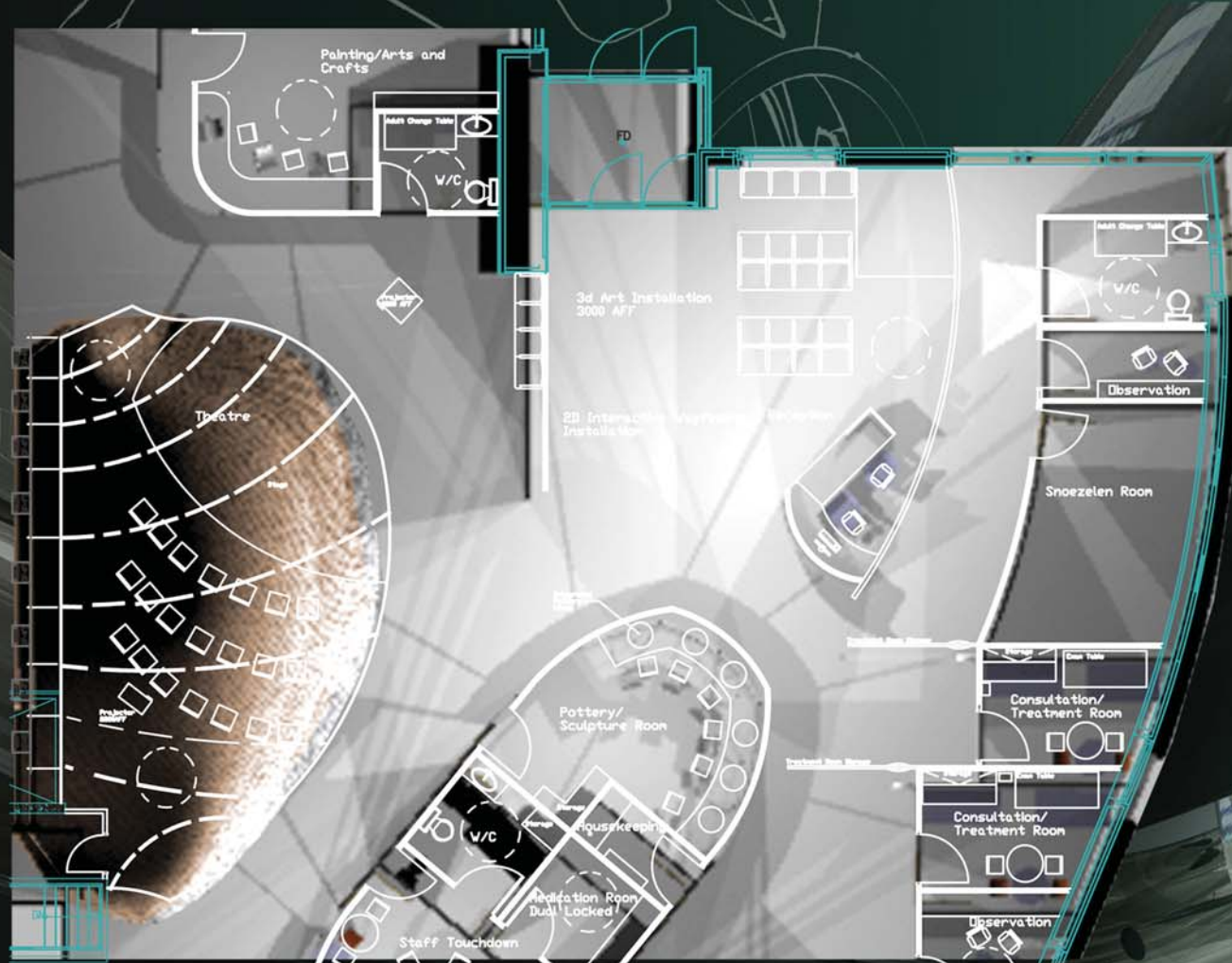

Focus Area- Theatre

Imagination and joy are integral to healing, and so the theatre was an obvious choice. The structure is a tensile fabric on an anchored aluminum frame. The fabric is translucent in specific areas, allowing projectors placed outside the theatre to create an environment within, effectively creating a starry night or a grassy meadow within the space. This reduces the need for props if a play is put on, or will give a child confined to the hospital the ability to go anywhere without leaving the premises.

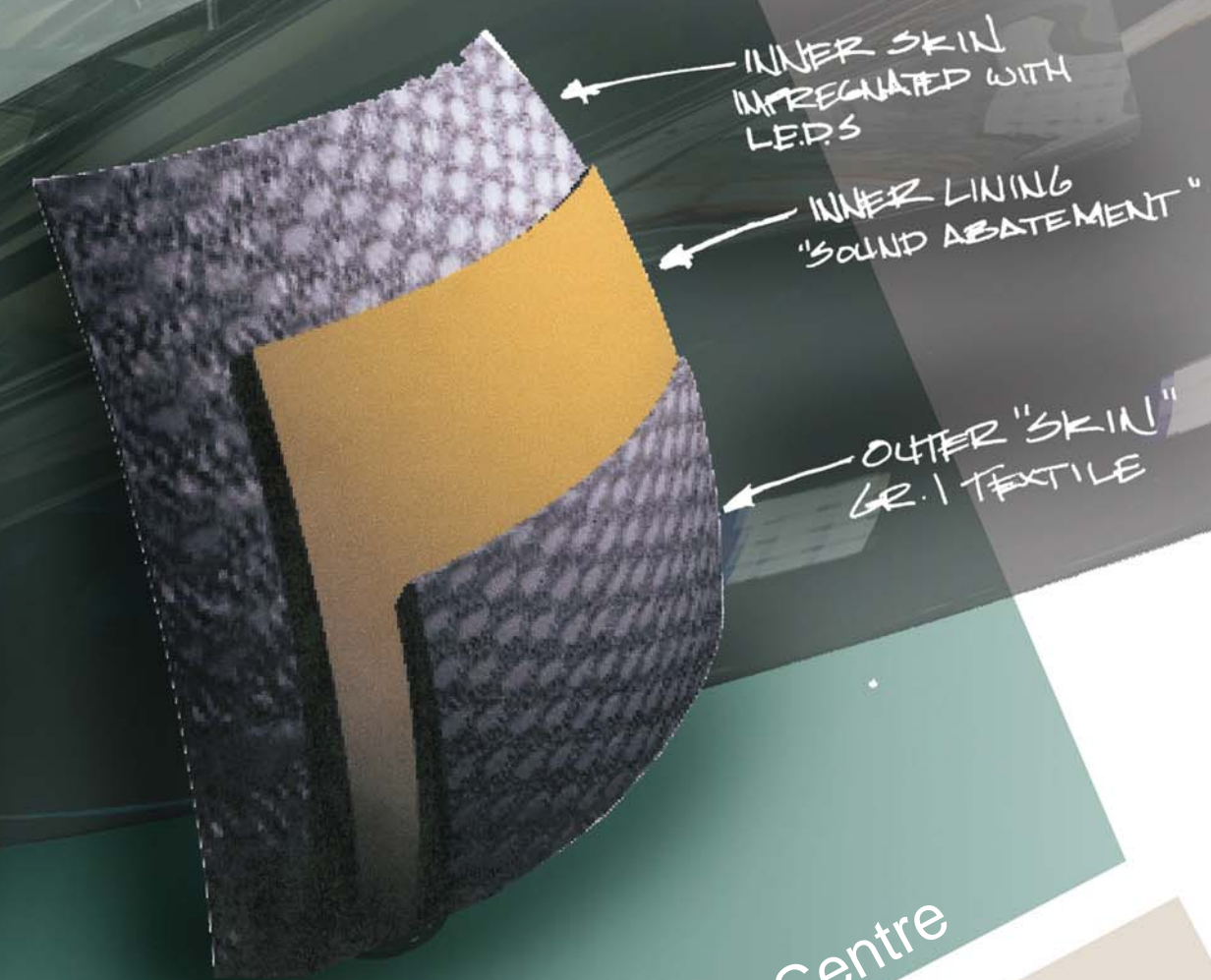
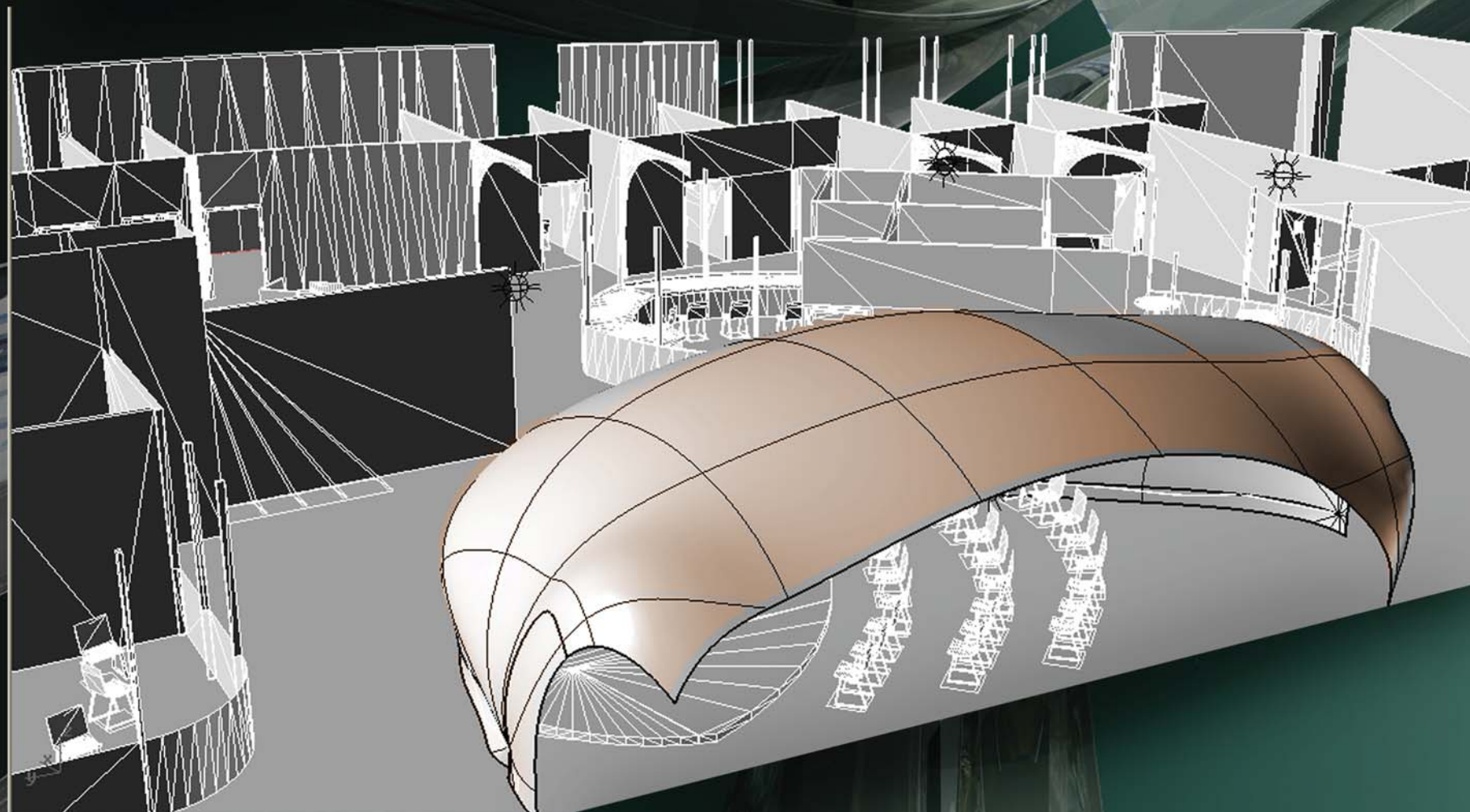

Rise Paediatric Centre



Concept

The act of recovery is not exclusively physical. The mind, and even the spirit, of the individual must also be accepting of the current state of the body, and be willing to put the trauma of illness into a frank and honest context. Lifting the burden of victimization or of self-blame is a delicate and often painful task in itself, but is an absolute necessity in order to heal wholly. Sometimes simply "telling it out" works, but there are few who can describe, in an adequate manner, their pain for cathartic release. This task is near impossible for children and teens, or even young adults, as these people must be given different means of expression.

The act of drawing is one of the most basic releases, and can be performed by almost anyone at almost any age. This kind of therapy is most suited to the very young, as even the most basic movements of a marker can express feelings of angst, aggression, or delight. This release allows the very young to move on emotionally, as well as stimulating the brain and improving motor functions.

For those who wish to create a more focused expression, painting is the next step. With painting, the basic act of drawing is augmented by a more sophisticated, emotional act. Laying brushstrokes and mixing paint provides a vast array of expressive movements, an infinite range of tone and colour fit for a more intense experience. Painting also takes time, and instilling in patients (especially young ones) the notion that good things can only be had with time and effort will provide a context for their own healing process.

After painting, sculpture is the next logical step in intensity and expression. The potter's wheel and clay are very physical things requiring moderate strength and consideration. It also provides new ways of viewing the world and the patient's situation. The acts of shaping and preparing the clay, and its interaction of this very raw natural substance with the man-made machine that is the pottery wheel, will hopefully show that cooperation between the natural healing process and the ingenuity of man can have beautiful results. Also, a certain amount of skill and concentration is needed, further emphasizing the concept of care and focus in all things.

Bridging the physical arts with the ephemeral is theatre. Spoken word and nuance of emotion is combined with physical movement and set. In the theatre, patients can be something else, larger than life. When the play is done, the actor retains part of the character played, and thus they become a little larger than life. Should there be some who wish to try their hand at playwriting, an instructor will be brought in once a week (all artistic disciplines will have instructors and mentors on a full and part-time basis). Staging performances will also be beneficial to parents as well, as they will be witnesses to their child's growth and happiness, hopefully drawing them and their child even closer during an undoubtedly stressful period.

Putting on a play is not an every day affair, so for the teen and young adult in need of expressive release, there is music. Music is probably the rawest form of expression, next to singing. Though bound by pattern and premeditated, music is nothing but sound, the jostling of molecules to induce and express emotion. It is in the moment, fleeting yet profound. Most importantly, it can be individualized or cooperative, bring many together to create a common or even discordant emotional set. Because of its ephemeral nature, those who wish to record and share their expression can do so via a house production studio and patient room supported mixing equipment. As with all other artistic endeavors, there will be knowledgeable and helpful staff who produce their own art as well. Ideally, the patient will take with them skills and experiences they can use for the rest of their lives, and give them a memory of growth and understanding.



RISE:ottawa

Signage and Artwork



Kinetic Interactive Sculpture
Located within the double-height area of the space, this piece will move and change shape as passers-by walk below it, or as those in the in-patient lounge move past its many sensors. Constructed of aluminum tube and fibre-optic/fabric mesh, the piece will also change color and light intensity depending on time of day and season. Small servo-motors and actuators move various parts of the substructure, creating an ever changing, fluid form.

Common Signage
All areas of the space shall have strictly pictographic, where applicable, the signs measure 500mmx500mm. The signs are thermoplastic dyed resin, mounted vertically with adhesive. The signage must have brail identification. Primary colours are to be used throughout. Signs shown are for the theatre, the pottery/sculpture area, and the recording studio, respectively.



RISE:ottawa

Rendered Floor Plans



RISE:ottawa

Board Graphic Layout

For this project, branding was extremely important to the relevance of the design in communicating the specific clientelle that would be inhabiting the space. Therefore, to maintain authenticity, I took a number of drawings my 3 year old had made and created a composite background for these boards. Bright colours blending together, not unlike experiences creating a mosaic of memories, give a sense of motion to an otherwise static presentation medium.

Rise Paediatric Centre



Dharma Arts

Issue 3 Winter 2008



 Article: Shannon Beahen

 Photo: Kenji Toyooka

"We want people to leave the show being more aware of their environment. If nothing else, be aware of what good lighting can do for a space," says Emond. Think about it; light is ever-present and mood altering. In darkness, it can empower you or transform what seems mundane by day into a magical display in the wee hours. In this case, light can increase traffic through a small neighbourhood gallery and illuminate a sector of the art world you might never have known existed. ■



Light In Flux

cover

1

2

3

4

5

6

7

8

9

10

11

12

13

gallery

credits



Candela Light Art Show

Candela is an annual showcase of light based art, with both artisits and lighting de-signers creating pieces to express the dy-namic nature of light.

This piece was selected for the 2008 show. It's constructed with a vast array of materials including aluminum, Plexiglass, a Delrin core, and calfskin leather.

Each ring contains over one hundred individual LEDs, and are air cooled via two variable speed fans on the back of each ring.



Prototype model

Candela 2008
Personal Work