

# Locker Rentals

## Pembroke Campus



### What program are you studying in at the Pembroke Campus?

Use this guide to know what floor is recommended for students in your program

| First Floor                             | Second Floor              | Third Floor   | Fourth Floor                   |
|---|---------------------------|---|--------------------------------|
| Bachelor of Science in Nursing (Year 1) | Early Childhood Education | Applied Nuclear Science & Radiation Safety                | Bachelor of Science in Nursing |
| Carpentry & Renovation Techniques       |                           | Business  | Personal Support Worker        |
| Forestry Technician                     |                           | Business Fundamentals                                     | Police Foundations             |
| Outdoor Adventure                       |                           | Computer Programming                                      | Practical Nursing              |
| Urban Forestry Arboriculture            |                           | Computer Systems Technician                               | Social Service Worker          |
|   |                           | Environmental Management & Assessment                     |                                |
|   |                           | Environmental Technician                                  |                                |
|   |                           | Pre-Health Science Pathway to Advanced Diplomas & Degrees |                                |
|   |                           | Regulatory Affairs  |                                |
|   |                           | Water and Wastewater Technician                           |                                |

### Locker Locations on Campus

#### First Floor

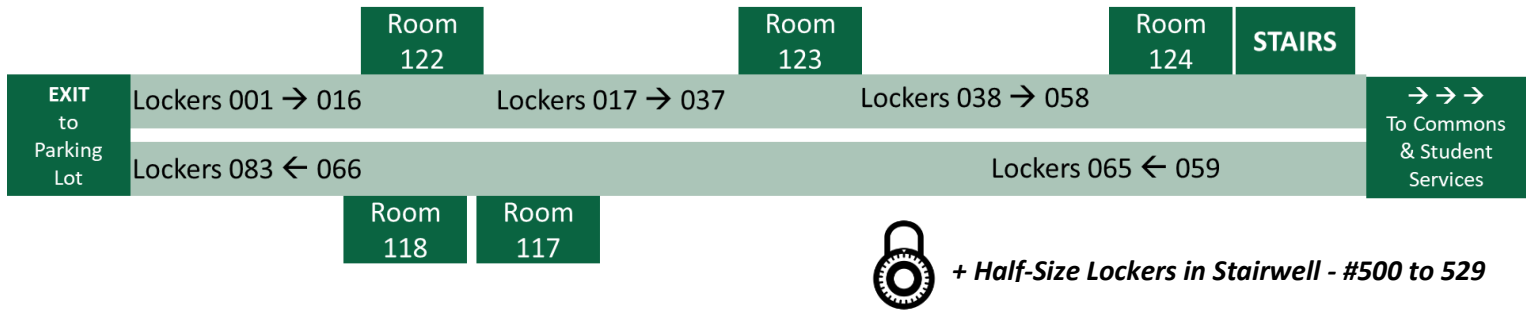

#### Second Floor

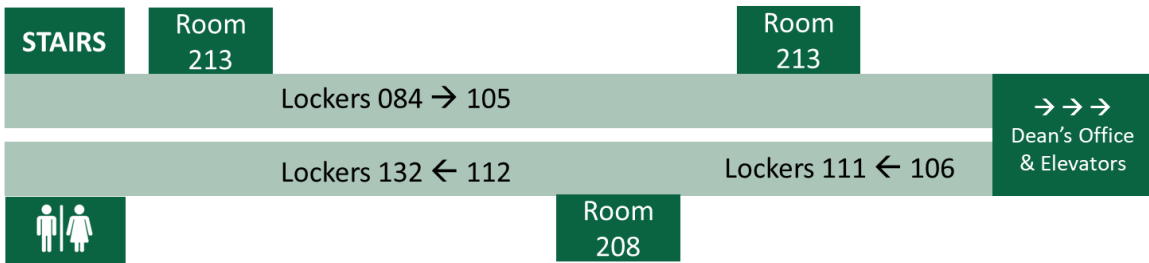

#### Third Floor

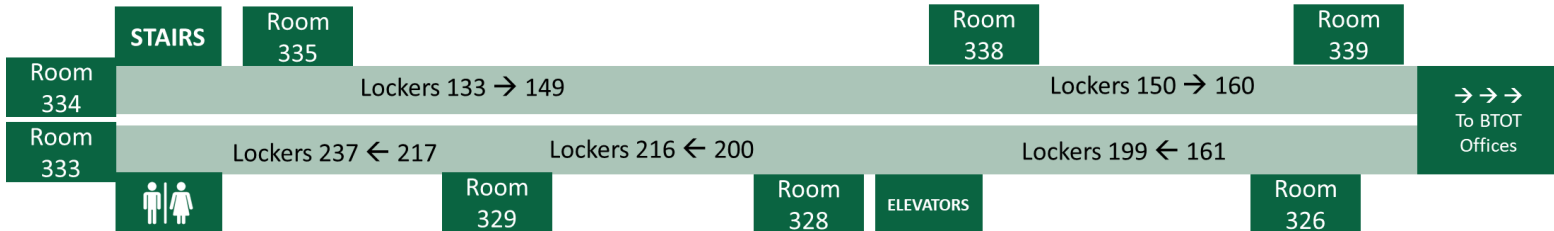

#### Fourth Floor

